

**UL US LISTED**  
 FILE #E65324  
 NEMA 4, 4X, 6, 6P

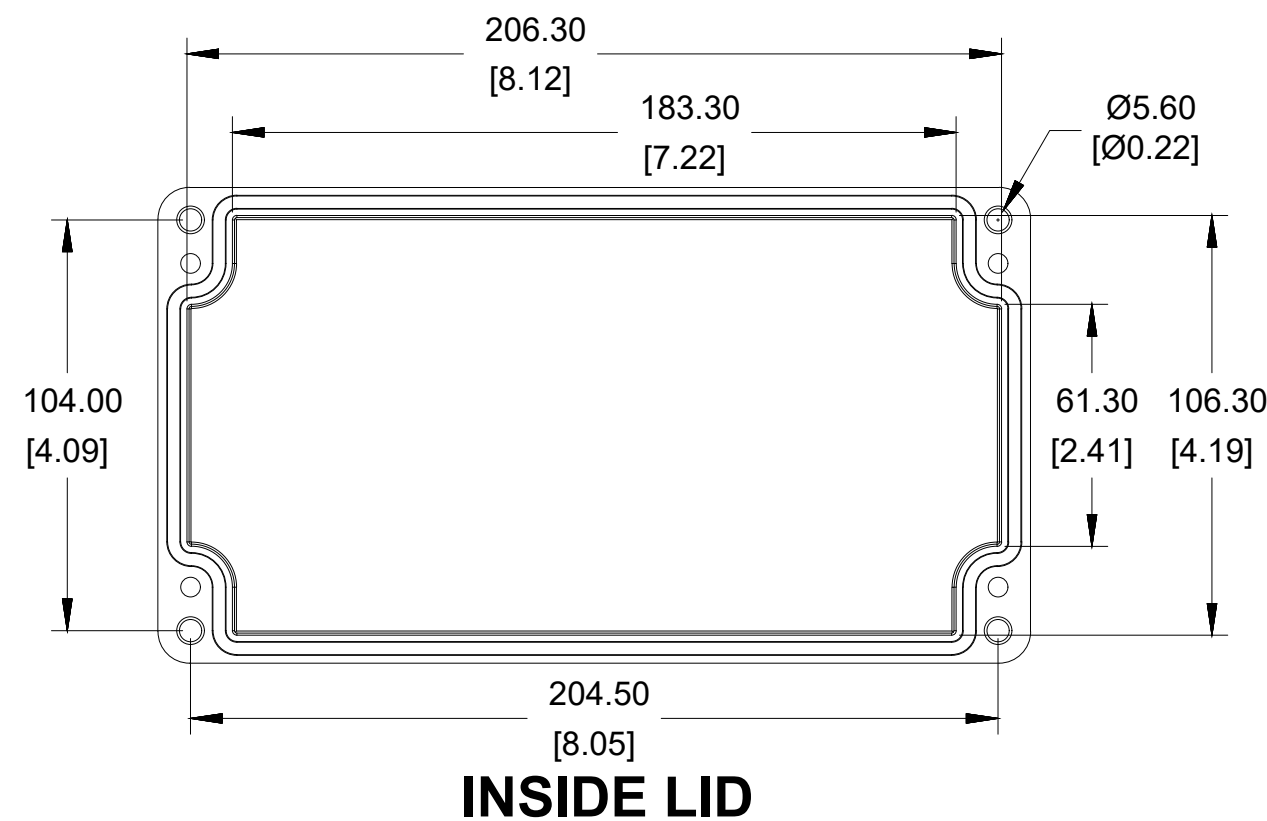

Enclosures can be Factory Modified ( Milling, Drilling, Printing etc.)  
 Contact Factory [mjm@hammondmfg.com](mailto:mjm@hammondmfg.com) for quotes  
 Solid models of this enclosure available in STEP or IGES.  
 (Part number and text placement/orientation on our products are subject to change,  
 we do not recommend using them as a locating reference for modification purposes)

NOTE	
Purchased assembly includes box, lid, silicone gasket, 4 cover screws and 4 ground screws with washers. Box and lid are made from Diecast Aluminum Alloy.	
Recommended cover screw Torque 15-17 lbf.in ( 150 -170 cN.m)	

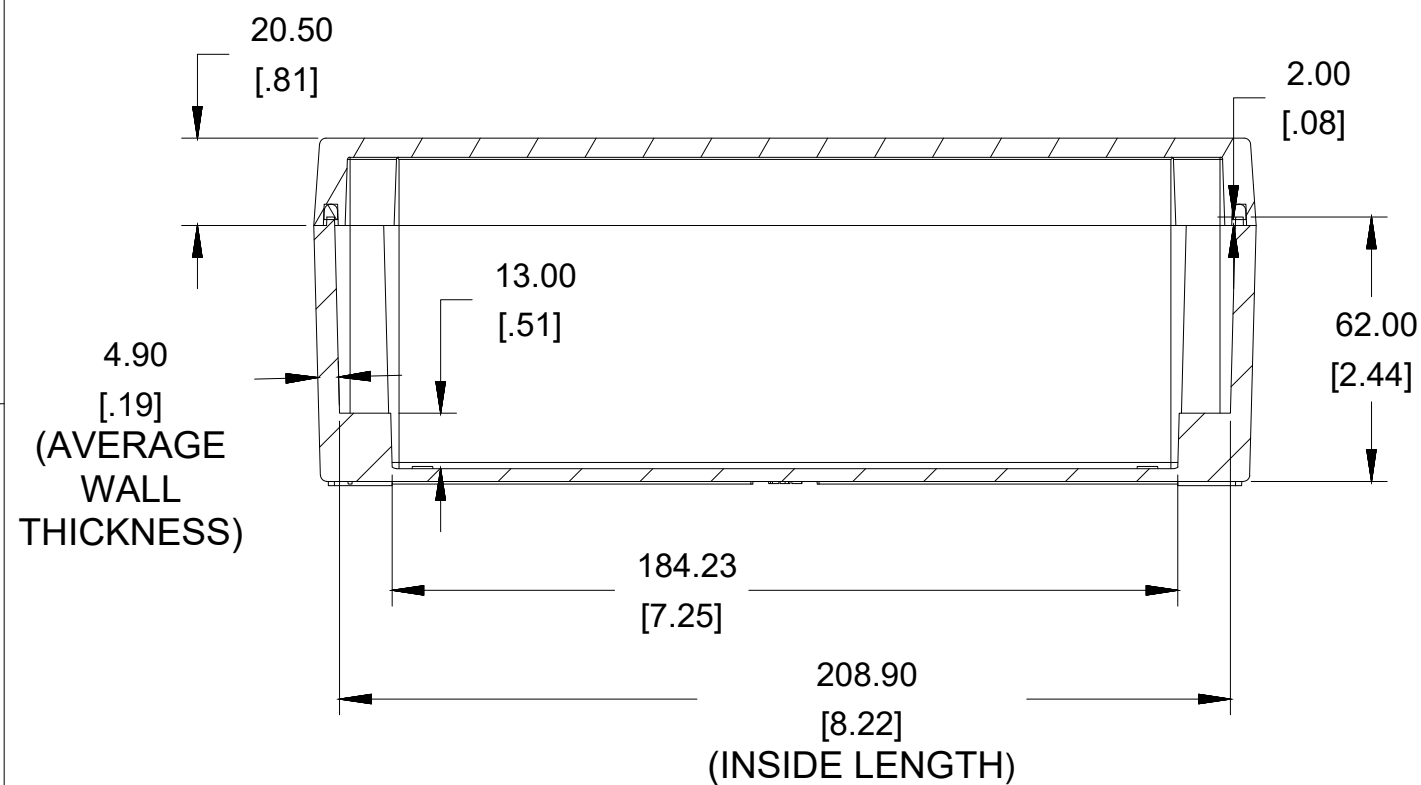
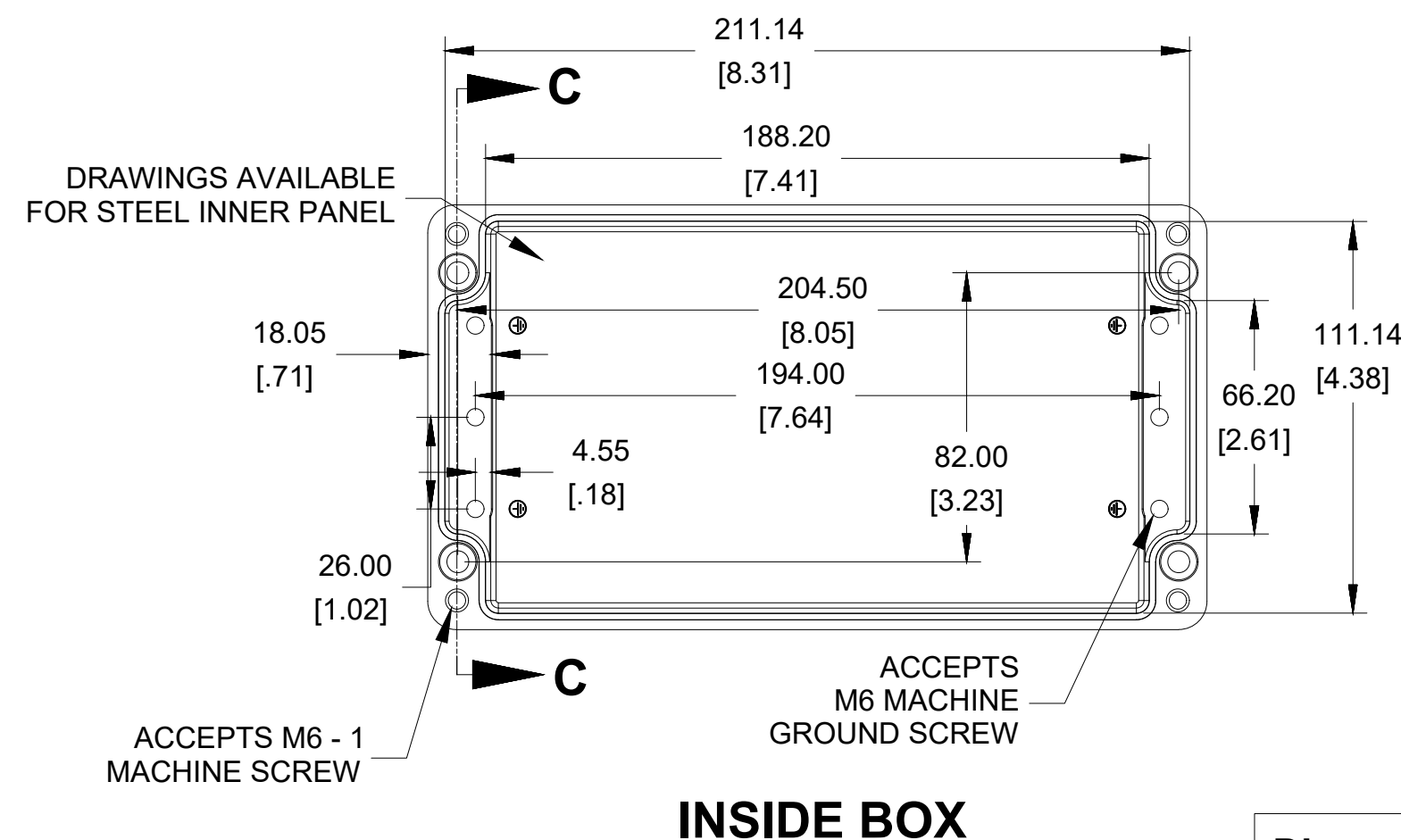
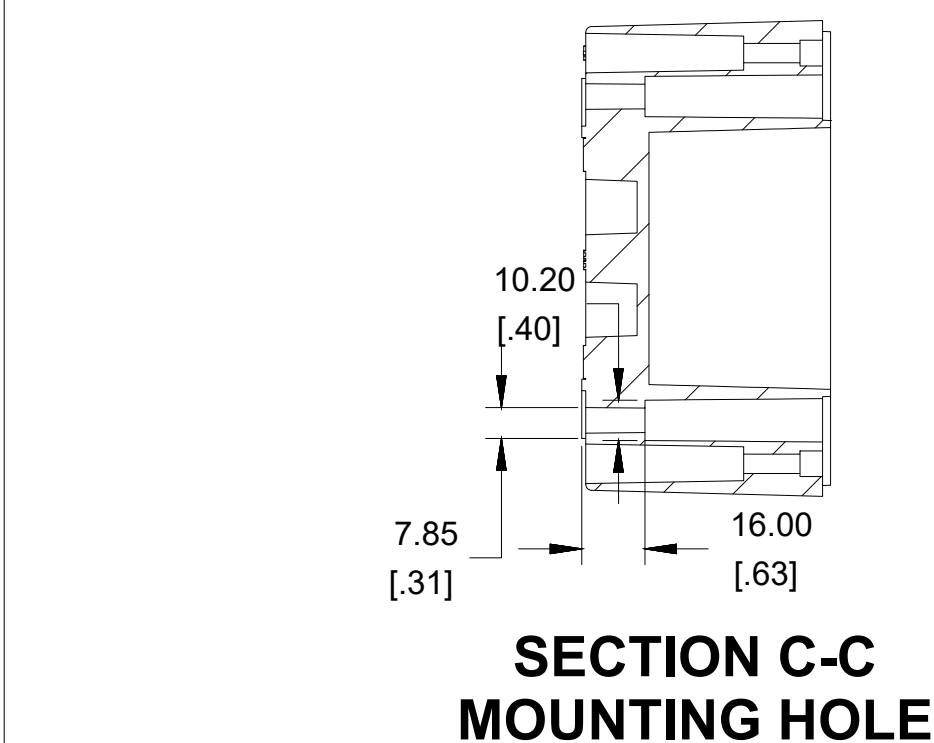

**Dimensions:**  
 mm  
 [inches]



**HAMMOND  
MANUFACTURING®**

**1590Z150**

[www.hammondmfg.com](http://www.hammondmfg.com)