

SECTION A-A
SIDE VIEW

SECTION B-B
END VIEW

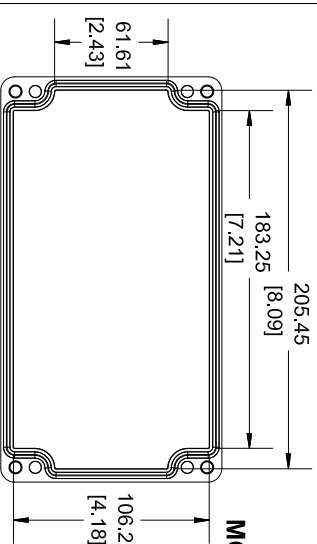

INSIDE LID

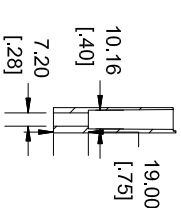

SECTION C-C
MOUNTING HOLE

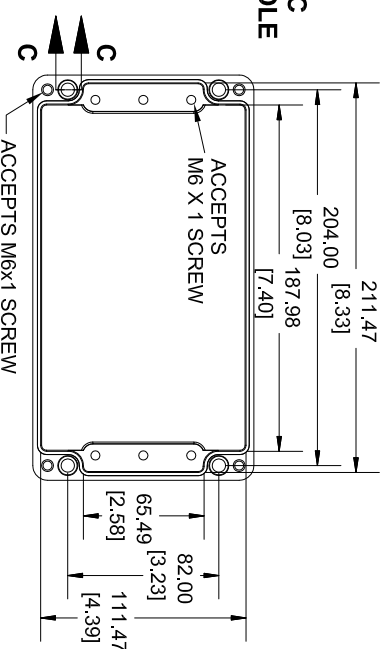

INSIDE BOX

cUL US LISTED
FILE #E66324
NEMA 4, 4X

Solid models of this enclosure available in .stp or .x_t
(Part number and text placement/orientation on our products are subject to change,
we do not recommend using them as a locating reference for modification purposes)

NOTE

Purchased assembly includes Box, Lid, Gasket and 4 cover screws
Enclosure Molded from Glass Reinforced Polyester

Recommended cover screw torque 13.3-17.7 lbf.in (150-200 cN.m)

PART NUMBERS	
1590ZGRP123 Enclosure	1590ZGRP123BK
ACCESSORIES	
Copper Ground Hardware (20 Pack) [M6 - 1.0 X 6mm / M6 Washer]	SCGM6GRP-20
Stainless Steel Cover Screw (20 Pack) [M6 - 1.0 X 30mm]	SCS70-20
Steel Inner Panel	1590ZGRP123PL
Hinge Kit Black (2 Pack)	1427HKBK

HAMMOND
MANUFACTURING®
1590ZGRP123BK
www.hammondmtg.com

Dimensions:
mm
[inches]