

**TOP VIEW**

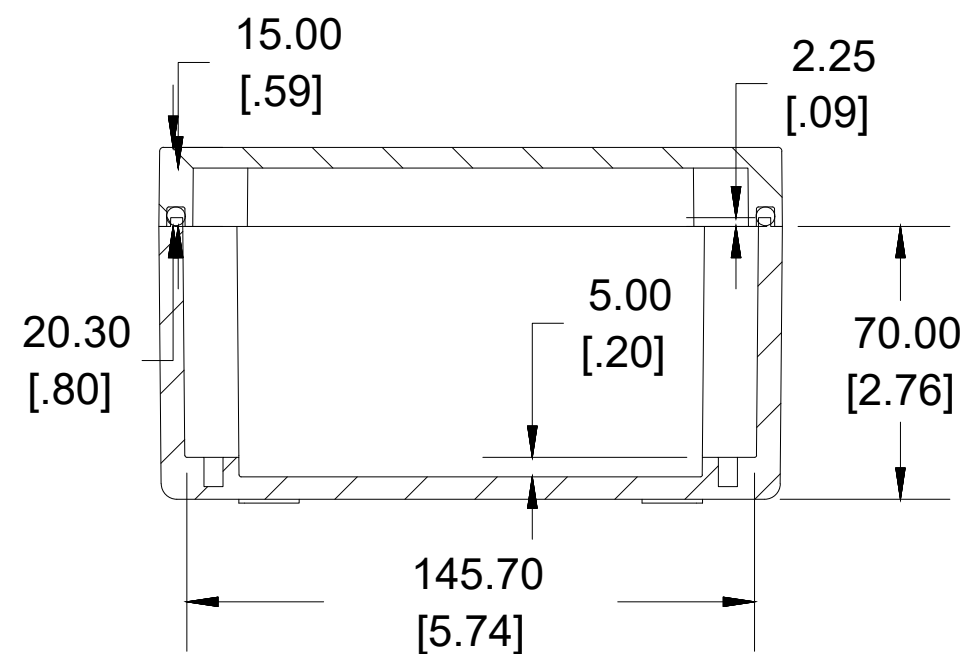

**SECTION A-A  
SIDE VIEW**

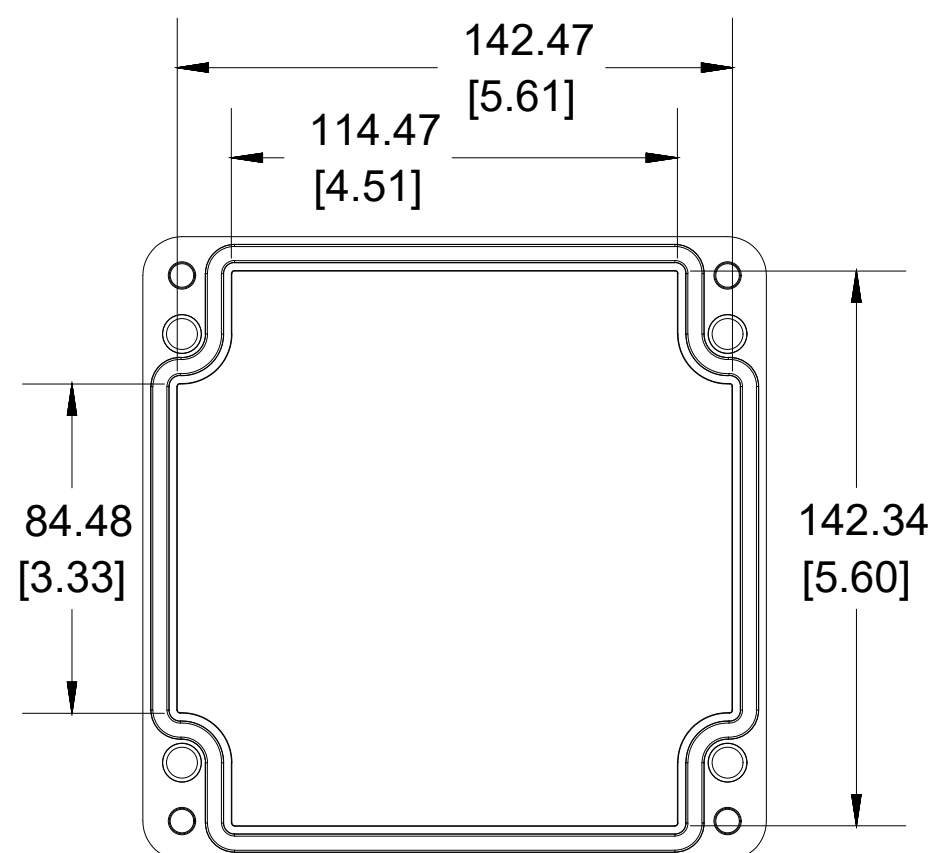

**INSIDE LID**

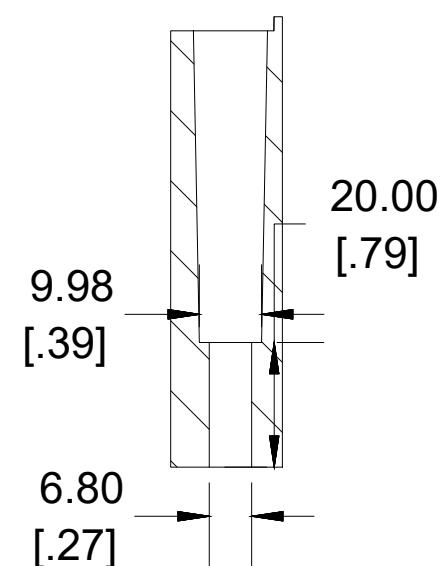

**SECTION C-C  
MOUNTING HOLE**

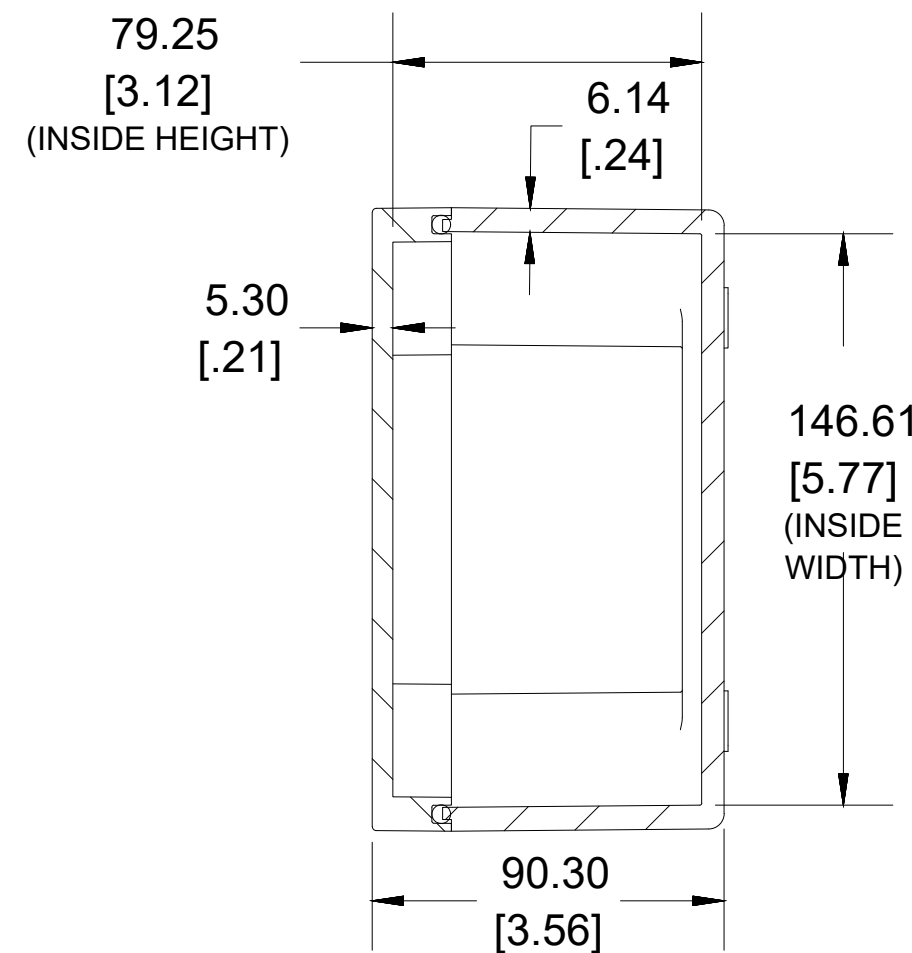

**SECTION B-B  
END VIEW**

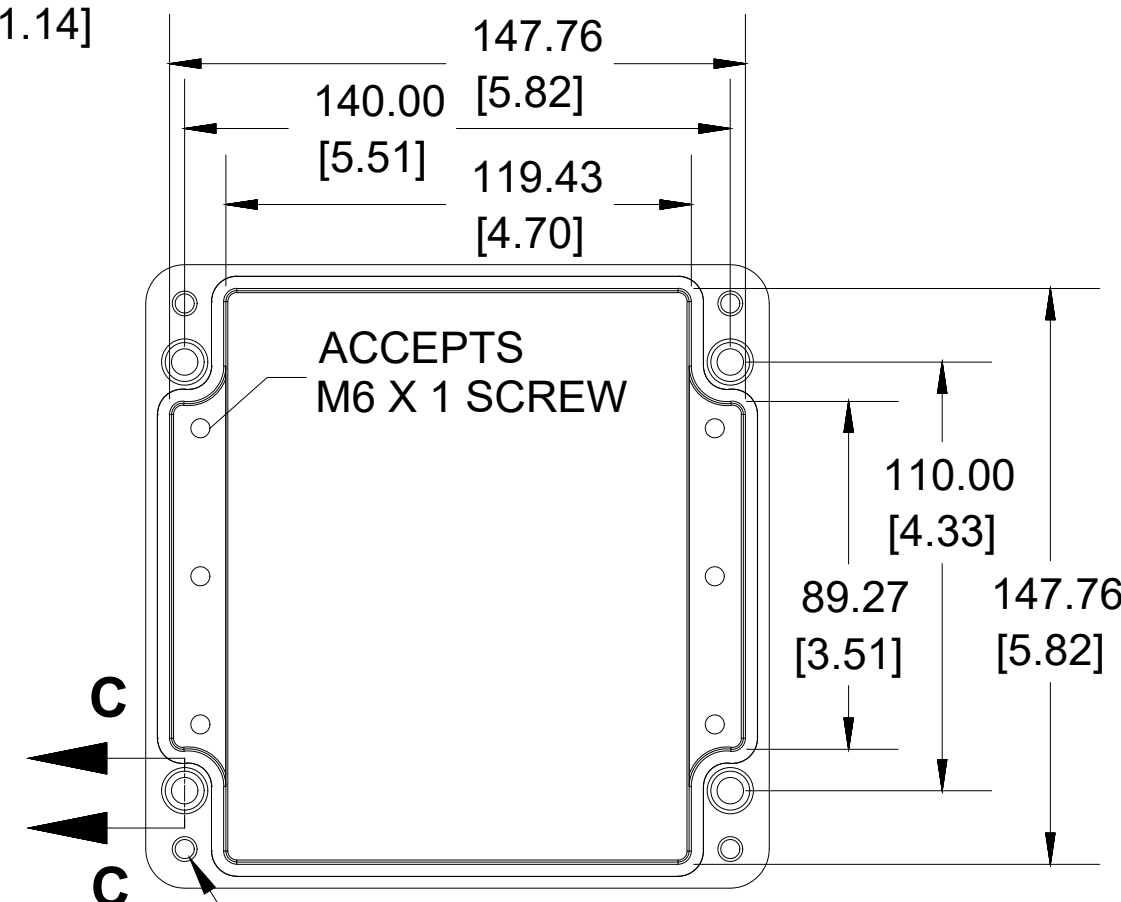
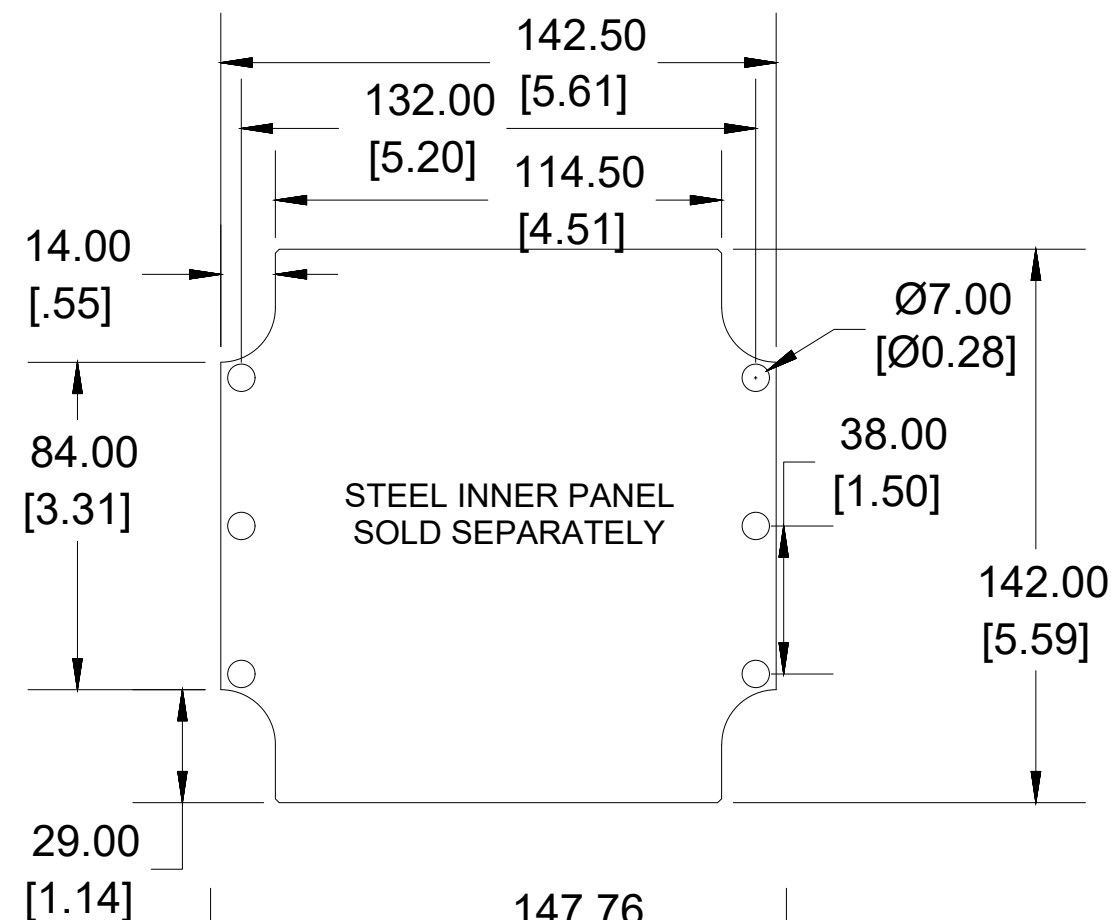

**INSIDE BOX**

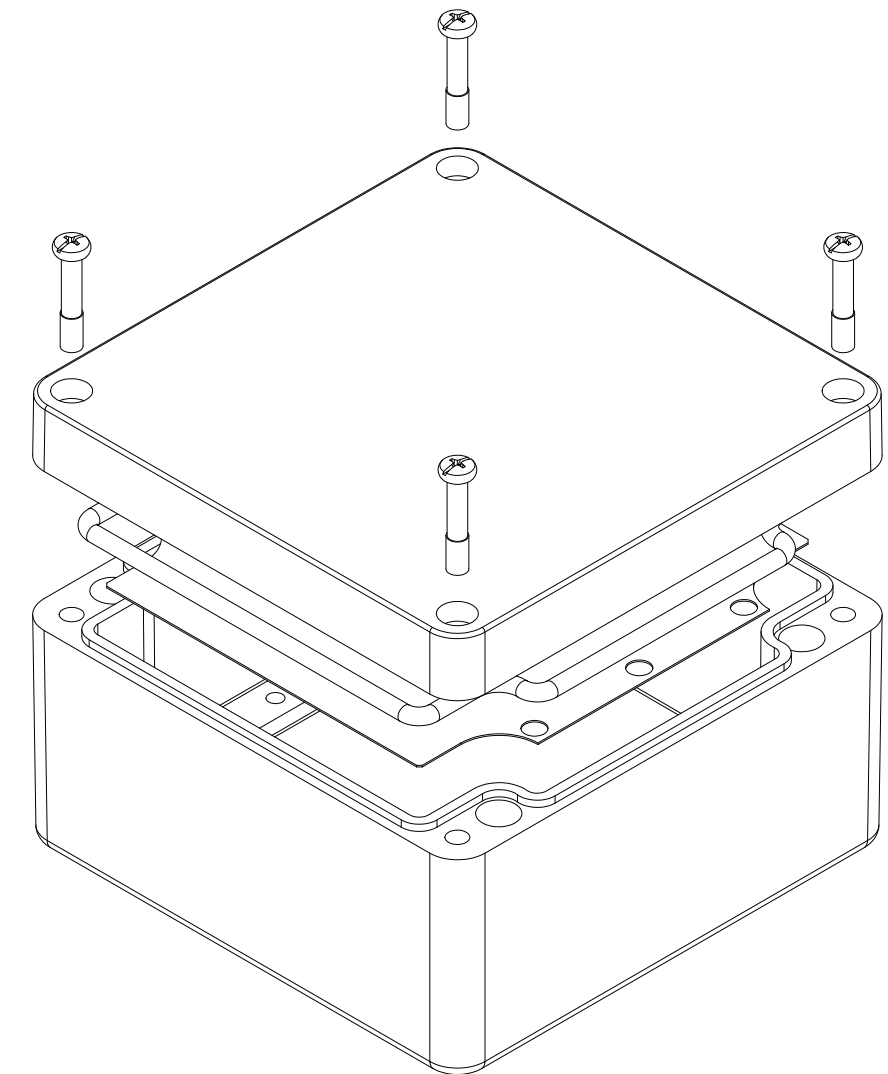

Enclosures can be Factory Modified ( Milling, Drilling, Printing etc.)  
 Contact Factory [mjm@hammondmfg.com](mailto:mjm@hammondmfg.com) for quotes  
 Solid models of this enclosure available in STEP or IGES.  
 (Part number and text placement/orientation on our products are subject to change,  
 we do not recommend using them as a locating reference for modification purposes)

**NOTE**

Purchased assembly includes Box, Lid, Gasket and 4 cover screws  
 Enclosure Molded from Glass Reinforced Polyester

**Recommended cover screw torque 8-9.5 lbf.in (90-110 cN.m)**

**PART NUMBERS**

**1590ZGRP161 Enclosure**

**Grey Enclosure**

**1590ZGRP161**

**ACCESSORIES**

**Copper Ground Hardware (20 Pack)**

**[M6 - 1.0 X 6mm / M6 Washer]**

**SCGM6GRP-20**

**Stainless Steel Cover Screw (20 Pack)**

**[M6 - 1.0 x 30mm]**

**SC570-20**

**Steel Inner Panel**

**1590ZGRP161PL**

**Hinge Kit (2 Pack)**

**1427HK**



Dimensions:  
mm  
[inches]