

DETAIL A

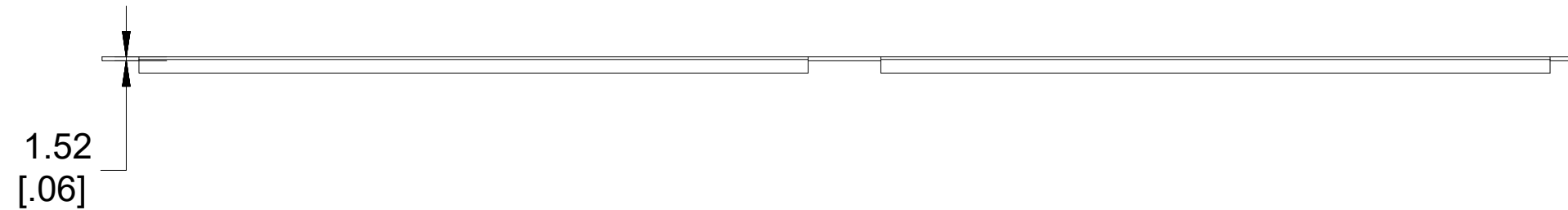
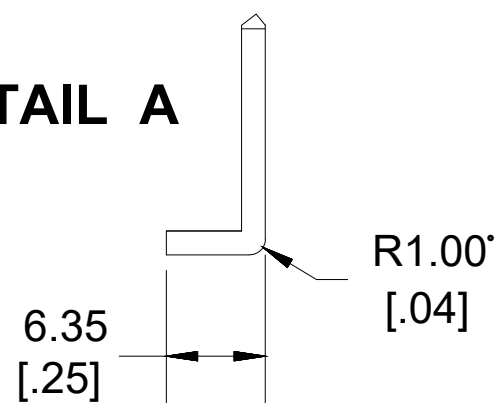

Enclosures can be Factory Modified (Milling, Drilling, Printing etc.)
Contact Factory mjm@hammondmfg.com for quotes
Solid models of this enclosure available in STEP or IGES.

NOTE

Purchased assembly includes Panel mounting screws and washers.
Panels are Galvanized steel 16 gauge.

Recommended Panel Screw Torque 45-50 cN-m [65-70 ozf-in]

1590ZGRP263PL

ACCESSORIES

Copper Plated Mounting Screw M6-1.0 X 6mm

SCGM6GRP



Dimensions:
mm
[inches]