

NOTE:
 SELECT AND INSTALL DESIRED ENODER BASE
 SELECT AND INSTALL DESIRED SLEEVE BORE INSERT
 2mm, 3mm, 3/8in, 4mm, 3/16in, 5mm, 6mm, 1/4in, 8mm

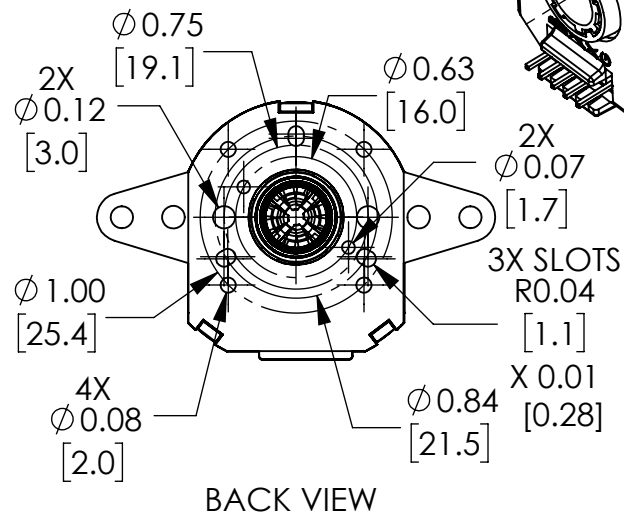
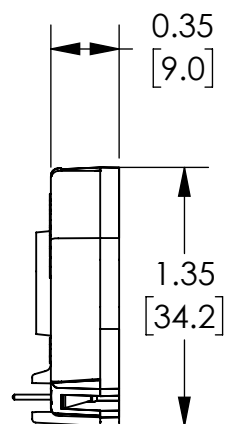
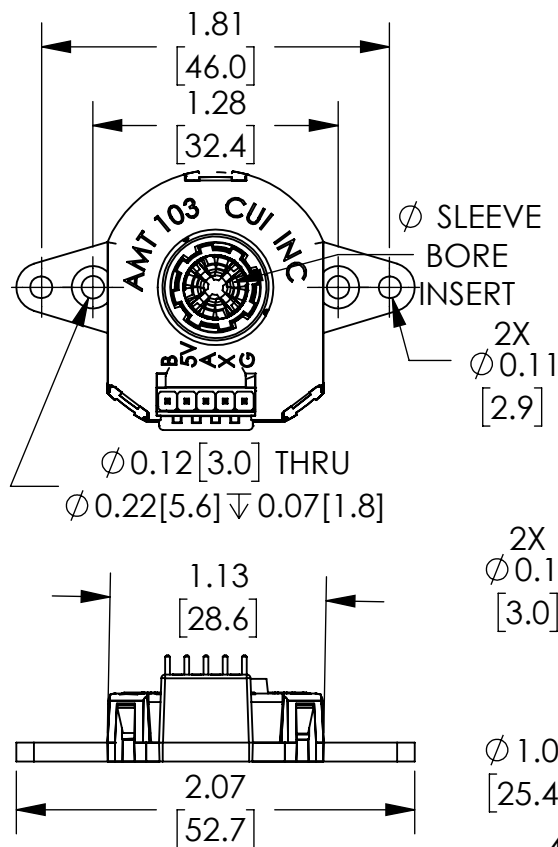

STANDARD BASE

ENCODER BODY

SLEEVE BORE INSERTS

WIDE BASE

NOTES:

1. DIMENSIONS CAN BE CHANGED BY MANUFACTURER WITHOUT NOTICE.
2. DIMENSIONS DO NOT IMPLY TOLERANCE.

AMT103-V

Units: inches [mm]

Scale: Full

CUI INCREMENTAL ENCODER, 5 VDC, AXIAL, TOTEM OUTPUT, FOR USE WITH NEMA 14, 17, 23 DUAL SHAFT MOTORS

AUTOMATIONDIRECT.com