

NOTE:  
 SELECT AND INSTALL DESIRED ENODER BASE  
 SELECT AND INSTALL DESIRED SLEEVE BORE INSERT  
 2mm, 3mm, 3/8in, 4mm, 3/16in, 5mm, 6mm, 1/4in, 8mm

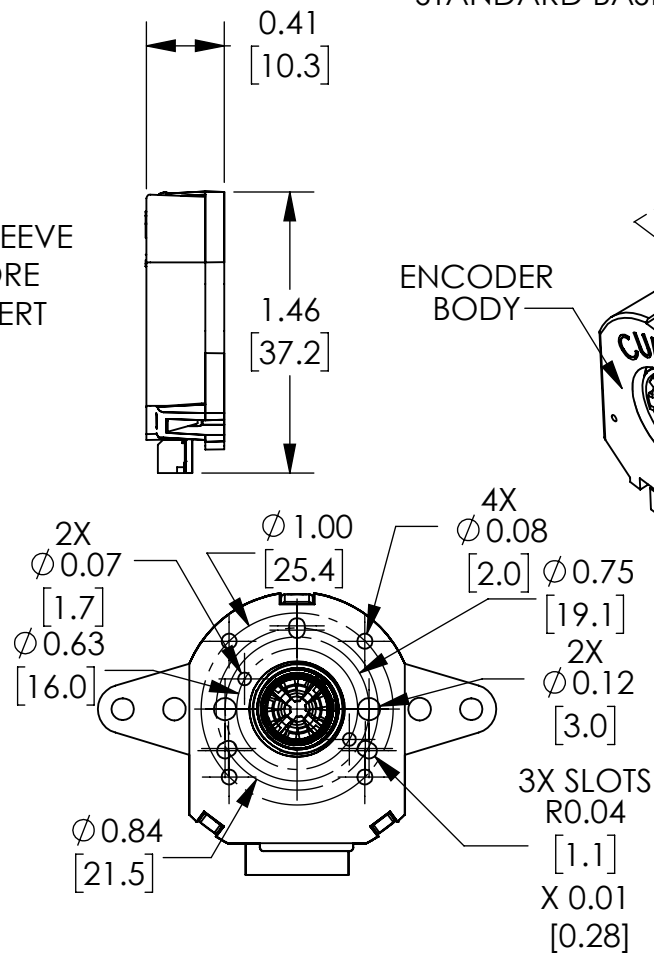

BACK VIEW

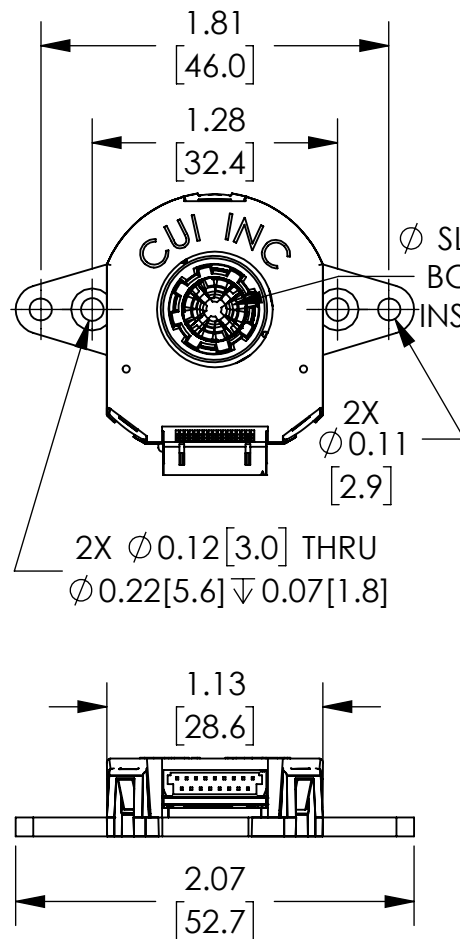
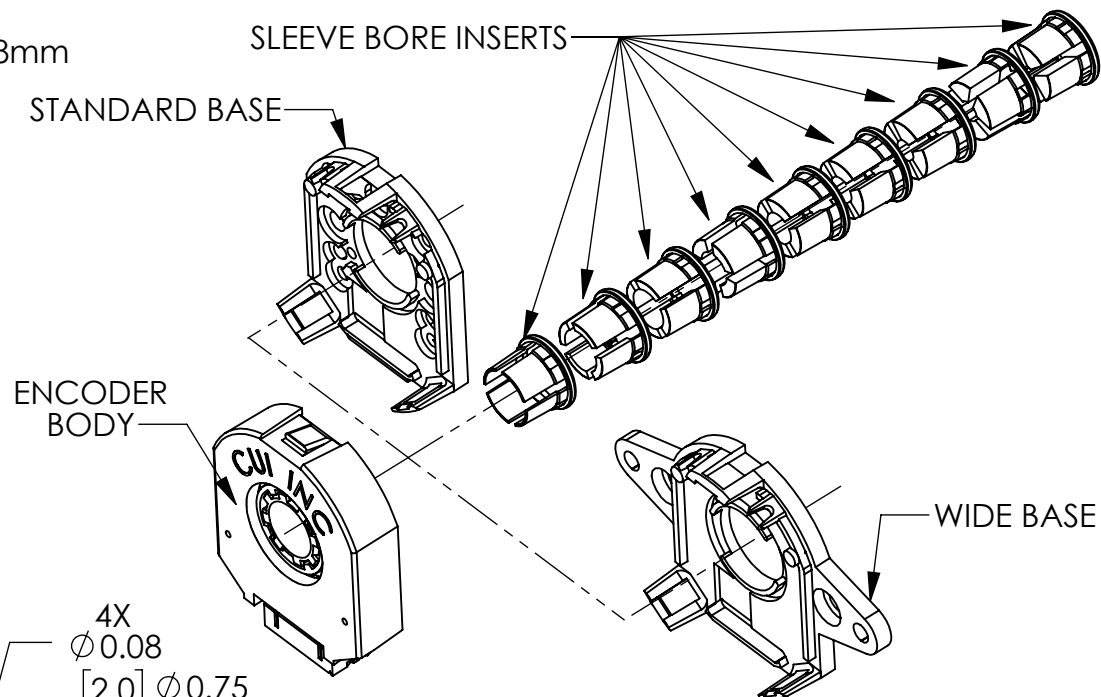

## NOTES:

1. DIMENSIONS CAN BE CHANGED BY MANUFACTURER WITHOUT NOTICE.
2. DIMENSIONS DO NOT IMPLY TOLERANCE.

AMT312D-V

Units: inches [mm]

Scale: Full

CUI INCREMENTAL MODULAR  
 ENCODER, 5 VDC, RADIAL, LINE  
 DRIVE OUT, FOR USE WITH NEMA  
 14,17,23, DUAL SHAFT MOTORS

**AUTOMATIONDIRECT**.com