

IF KEY WASHER OR LEGEND PLATE ARE NOT USED 4.8MM WIDE LOCATION HOLE NEED NOT BE CUT OUT

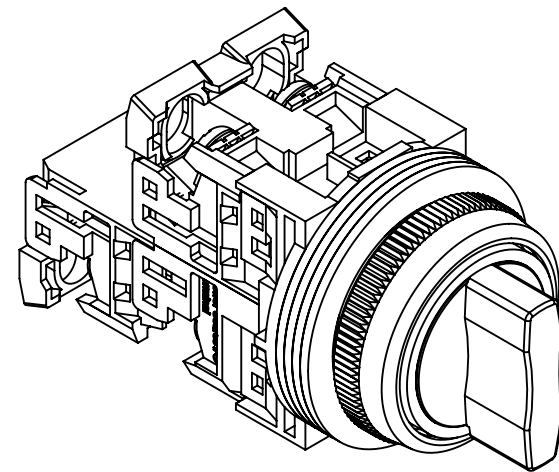

MOUNTING HOLES

M3.5 TERMINAL SCREWS

41.0 [1.61] 23.0 [0.91]

1.0 [0.04] PANEL THICKNESS

44.0 [1.73]

35.0 [1.38]

TERMINAL COVER

PACKING

61.0 [2.40]

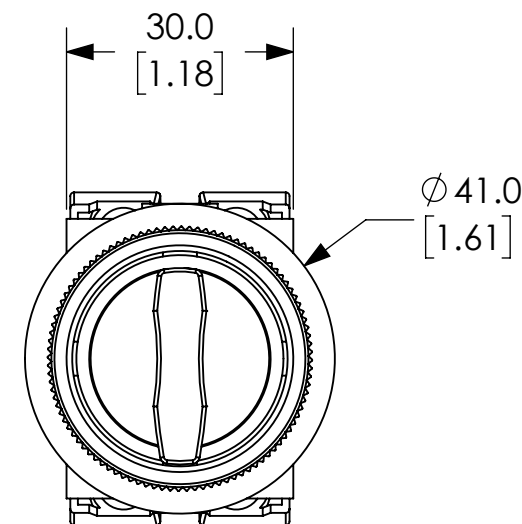

NOTES:

1. DIMENSIONS CAN BE CHANGED BY MANUFACTURER WITHOUT NOTICE.
2. DIMENSIONS DO NOT IMPLY TOLERANCE.

AR30PL-611E3AZC

Units: mm [inches]

Scale: Full

SELECTOR SWITCH, KNOB, 3 POSITION, SPRING RETURN TO CENTER, LED 24V, ORANGE, 1-NO + 1-NC

AUTOMATIONDIRECT.com