

1.25-12  
THREAD  
BOTH ENDS

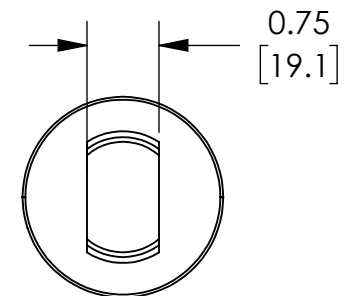

#### NOTES:

1. DIMENSIONS CAN BE CHANGED BY MANUFACTURER WITHOUT NOTICE.
2. DIMENSIONS DO NOT IMPLY TOLERANCE.

F32030DD

Units: inches [mm]

Scale: Full

NITRA PNEUMATIC CYLINDER:  
STAINLESS, 2" BORE, 3.0" STROKE

**AUTOMATIONDIRECT**.com