

- 1 = TRANSMITTER DIODE
2 = RECEIVER DIODE
3 = SCREW M4 - 0.5 Nm

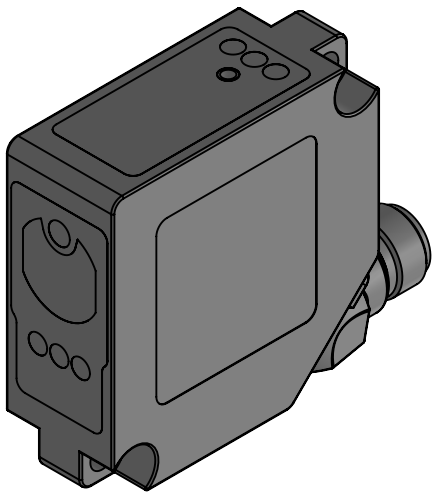

ISOMETRIC VIEW

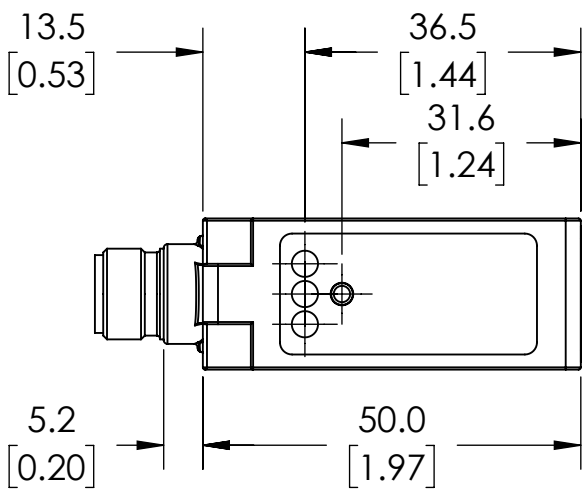
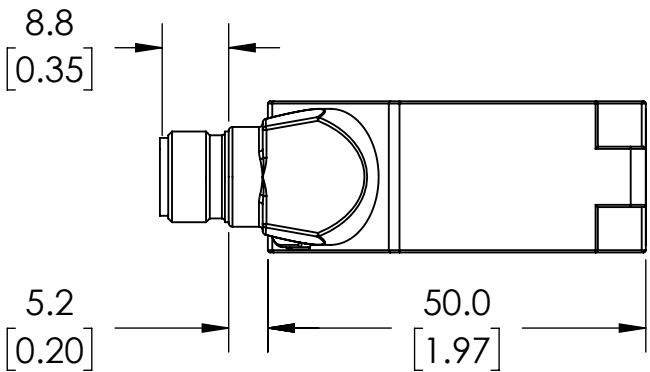
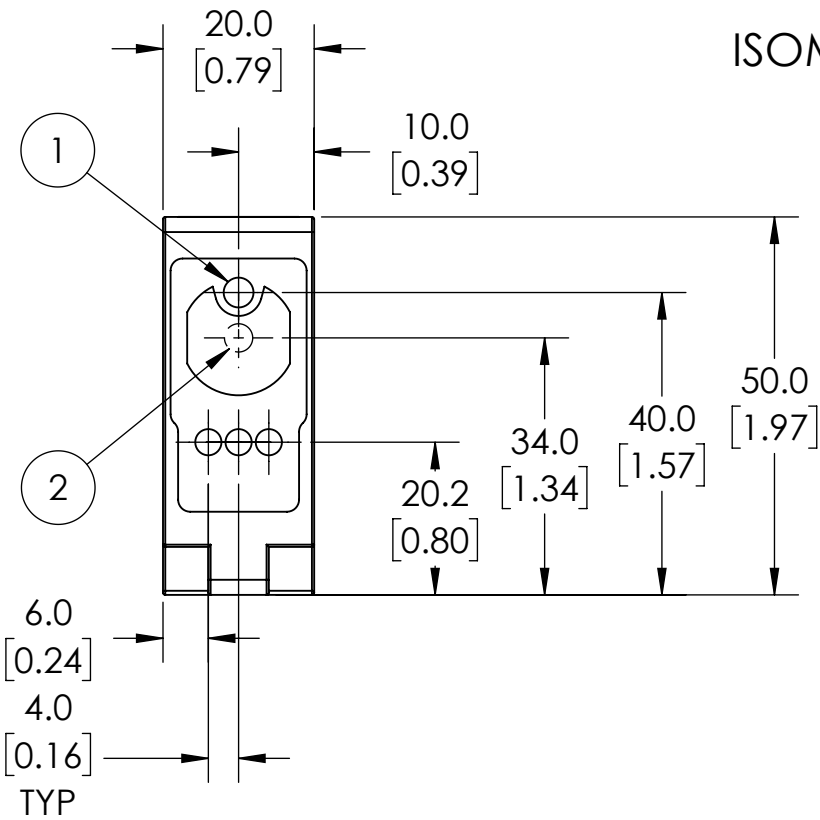
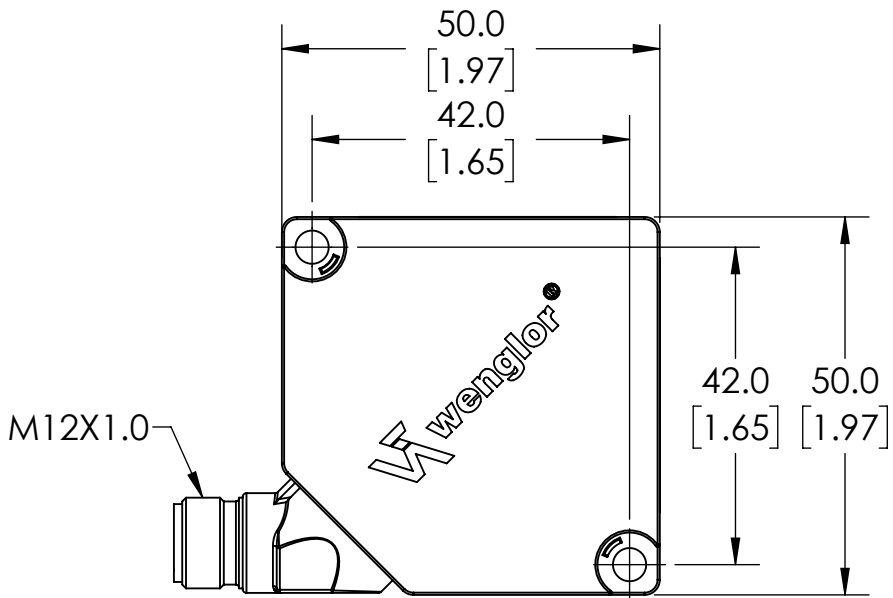
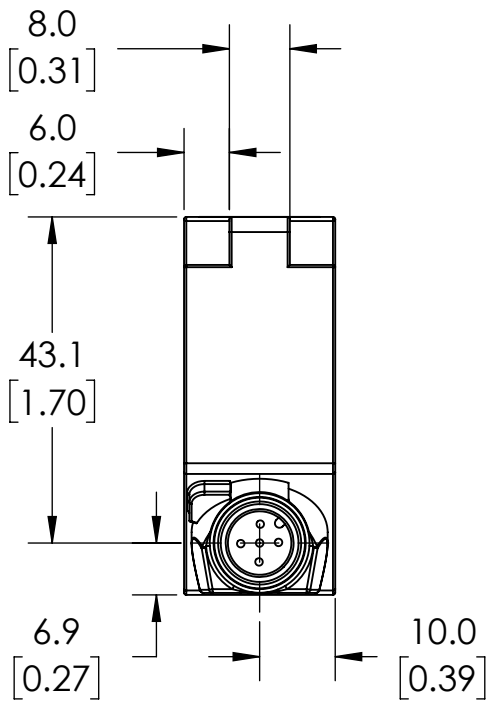

NOTES:

1. DIMENSIONS CAN BE CHANGED BY MANUFACTURER WITHOUT NOTICE.
2. DIMENSIONS DO NOT IMPLY TOLERANCE.

OPT2171
Units: mm [inches] Scale: Full
WENGLOR PHOTOELECTRIC LASER SENSOR, DIFFUSE WITH BACKGROUND SUPPRESSION, 50 X 50 X 20MM, CLASS 1 LASER LIGHT EMISSION, 0- 3M SENSING DISTANCE, 10-30 VDC OPERATING VOLTAGE, NPN, IO-LINK COMPATIBLE, 5-PIN M12 QUICK-DISCONNECT
