

THE INFORMATION CONTAINED IN THIS DRAWING IS THE SOLE PROPERTY OF STAHLIN ENCLOSURES. ANY REPRODUCTION IN PART OR WHOLE WITHOUT THE WRITTEN PERMISSION OF STAHLIN ENCLOSURES IS PROHIBITED.

REVISIONS			
REV.	DESCRIPTION	DATE	APPROVED

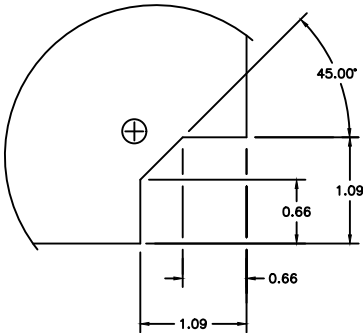
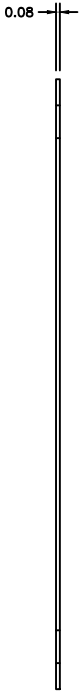
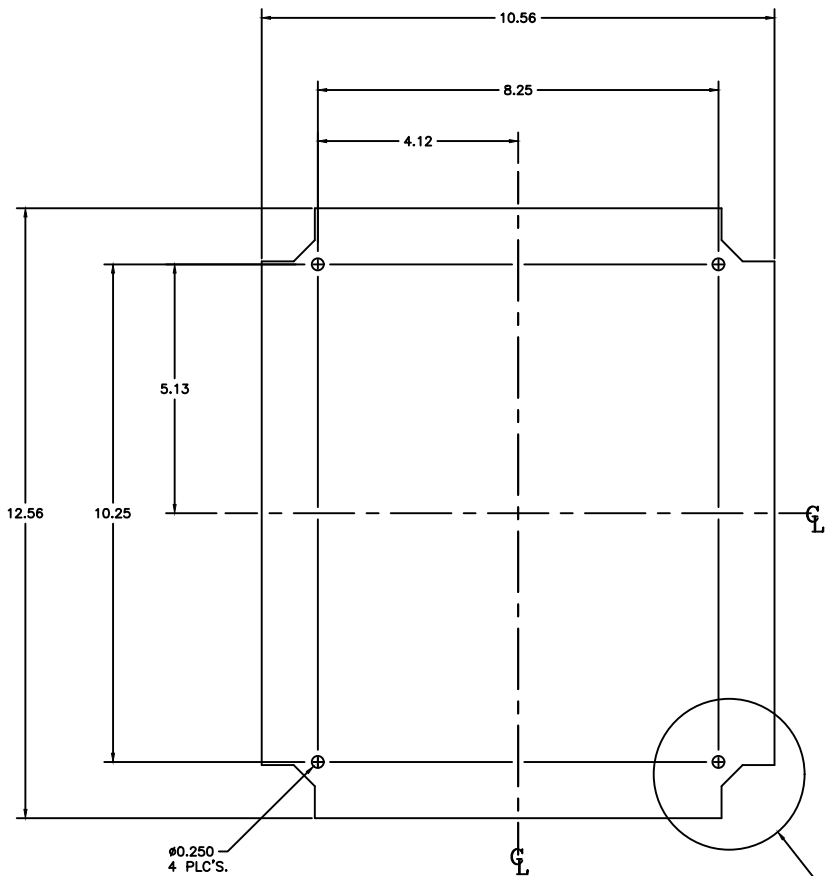

DETAIL A
TYP. 4 PLC'S.

SEE DETAIL A

- NOTE:
1. PARTS TO BE FREE FROM BURRS & SHARP EDGES
 2. PANEL TO HAVE WHITE PVC ON ONE SIDE
 3. PANELS MUST BE FLAT

NOTES:									
DO NOT SCALE DRAWING								TOLERANCES UNLESS SPECIFIED	DECIMAL .XXX ± 0.005 .XX ± 0.010
MATERIAL ALUMINUM 3003 H14 MILL FINISH						DR. BY GF	DATE 6-1-01	ATTABOX ENCLOSURES	
LET.	REVISION RECD			DATE	BY	CHK. BY	DATE		
A	PART NUMBER WAS AT701210			1/24/02	GF			CUSTOMER	
						APD. BY	DATE		
								SCALE NAME FULL	
								PART NAME STATIONARY PANEL	
								PART NO. ATP1210STA	

AutoCAD DWG. FILE
P1210STA

BELDING, MICHIGAN
48809