

LINE SIDE

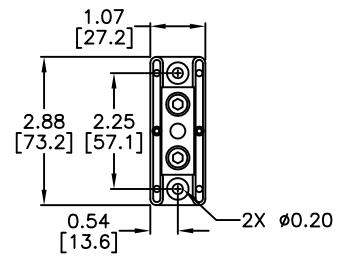

LOAD SIDE

Notes:

1. Dimensions can be changed by Manufacturer without notice.
2. Dimensions do not imply tolerance.

PB1011

Units: inches [mm]

Scale: Full

DISTRIBUTION BLOCK, OPEN,
UL RECOGNIZED, 175A, 1P,
4-OUT, 1-IN

AUTOMATIONDIRECT.com