

LINE SIDE

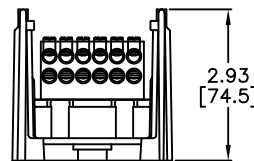
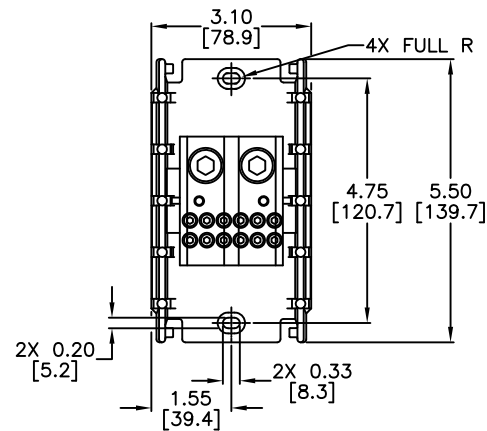
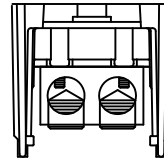

LOAD SIDE

Notes:

1. Dimensions can be changed by Manufacturer without notice.
2. Dimensions do not imply tolerance.

PB7121

Units: inches [mm]

Scale: Full

DISTRIBUTION BLOCK, OPEN,
UL RECOGNIZED, 760A, 1P,
12-OUT, 2-IN

 **AUTOMATIONDIRECT**.com