

# SAGINAW CONTROL & ENGINEERING

## SCE-LPCLAMP

OPEN  
POSITION

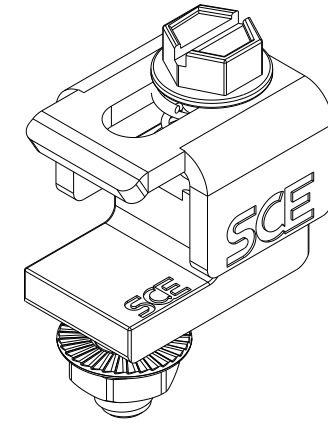
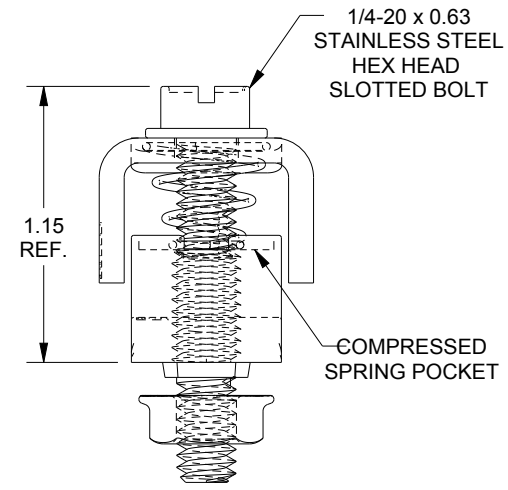
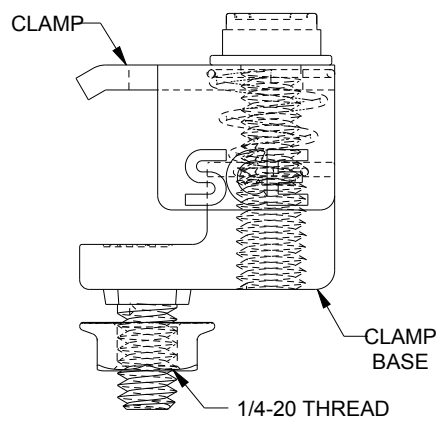
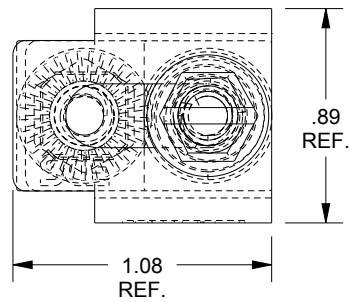

OPEN  
POSITION

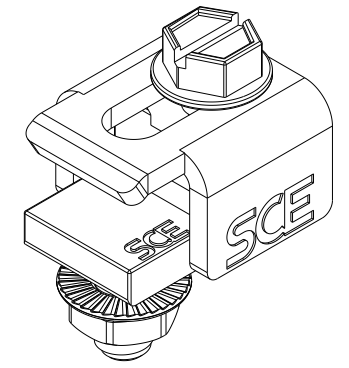

CLOSED  
POSITION

CLOSED  
POSITION

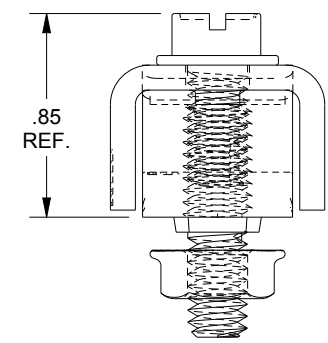
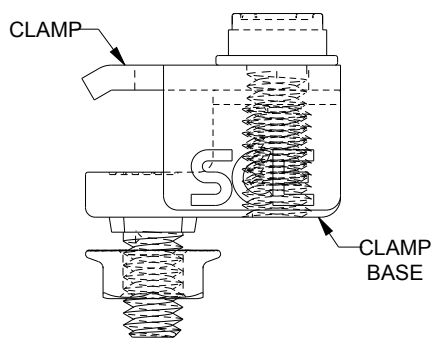
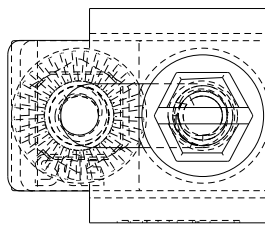

| BILL OF MATERIAL |     |   |
|------------------|-----|---|
| ITEM             | QTY | PART DESCRIPTION  |
| 1                | 1   | Base, LP-Style, Zamak 5 Die Cast, Used in 120132                    |
| 2                | 1   | Clamp, LP-Style, 304 Stainless Steel, Used in 120132                |
| 3                | 1   | Nut, Serrated Flange, 1/4-20 Steel, Zinc                            |
| 4                | 1   | Screw, Hex Head, Slotted, Flanged, 1/4-20 X 5/8, Stainless Steel    |
| 5                | 1   | Spring, Compression, Tapered, 0.035" Dia., 304 Stainless Steel Wire |