

**LASER SENTINEL FEATURES
(STAND ALONE MODEL)**

- 1.) LASER SCANNER WINDOW
- 2.) DISPLAY
- 3.) LED INDICATORS
- 4.) ETHERNET CONNECTOR
- 5.) KEYPAD
- 6.) I/O CONNECTOR
- 7.) DIRECT MOUNTING HOLES

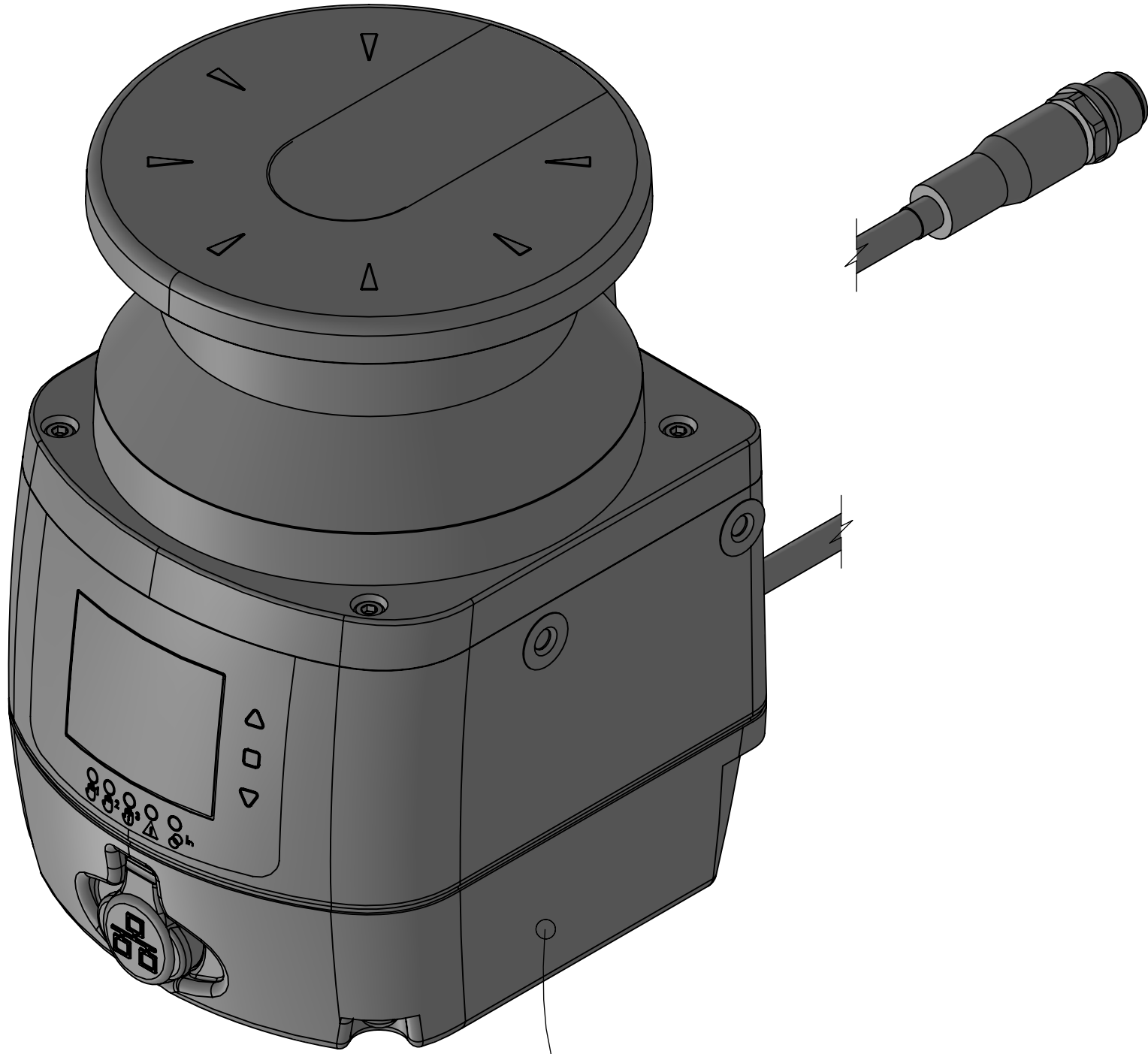

ISOMETRIC VIEW

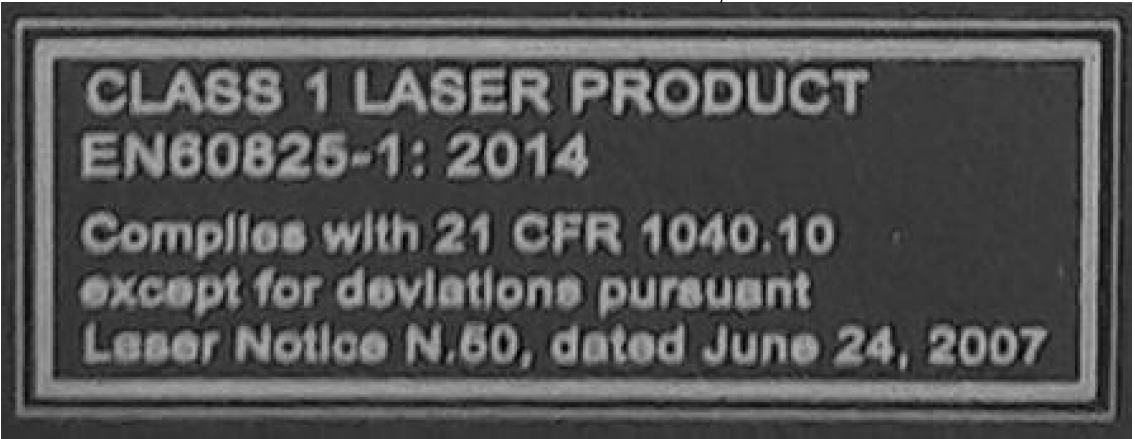
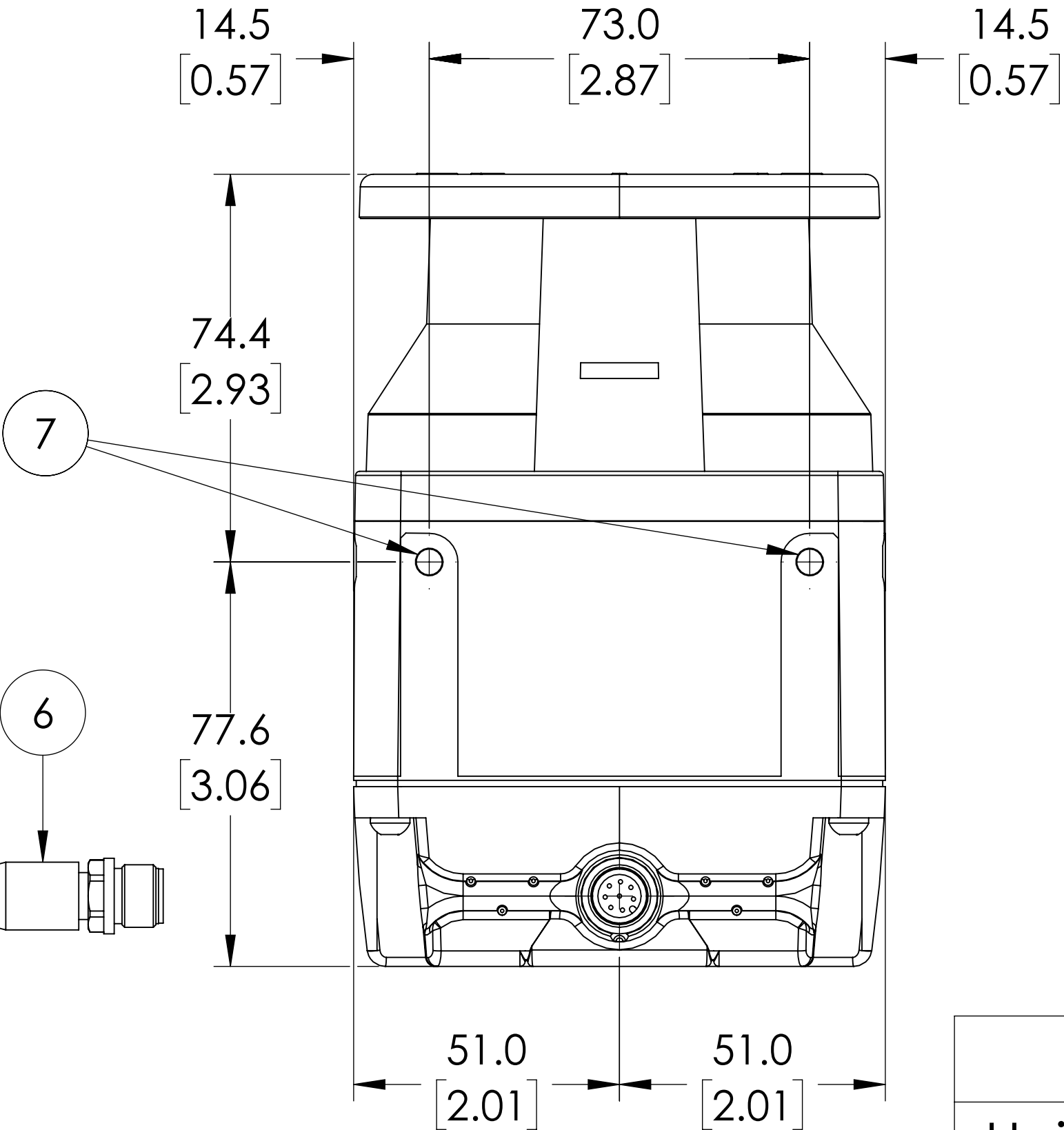
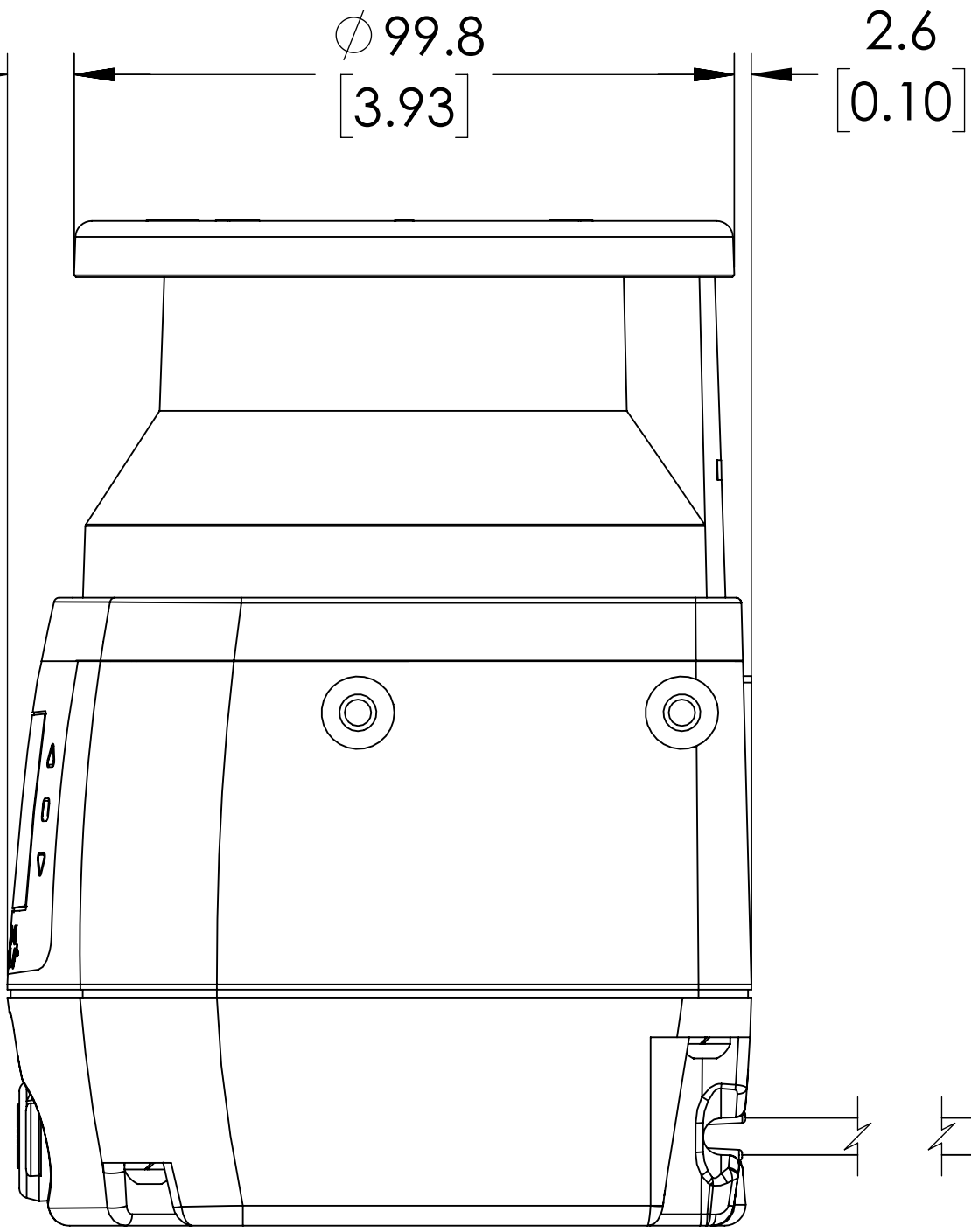
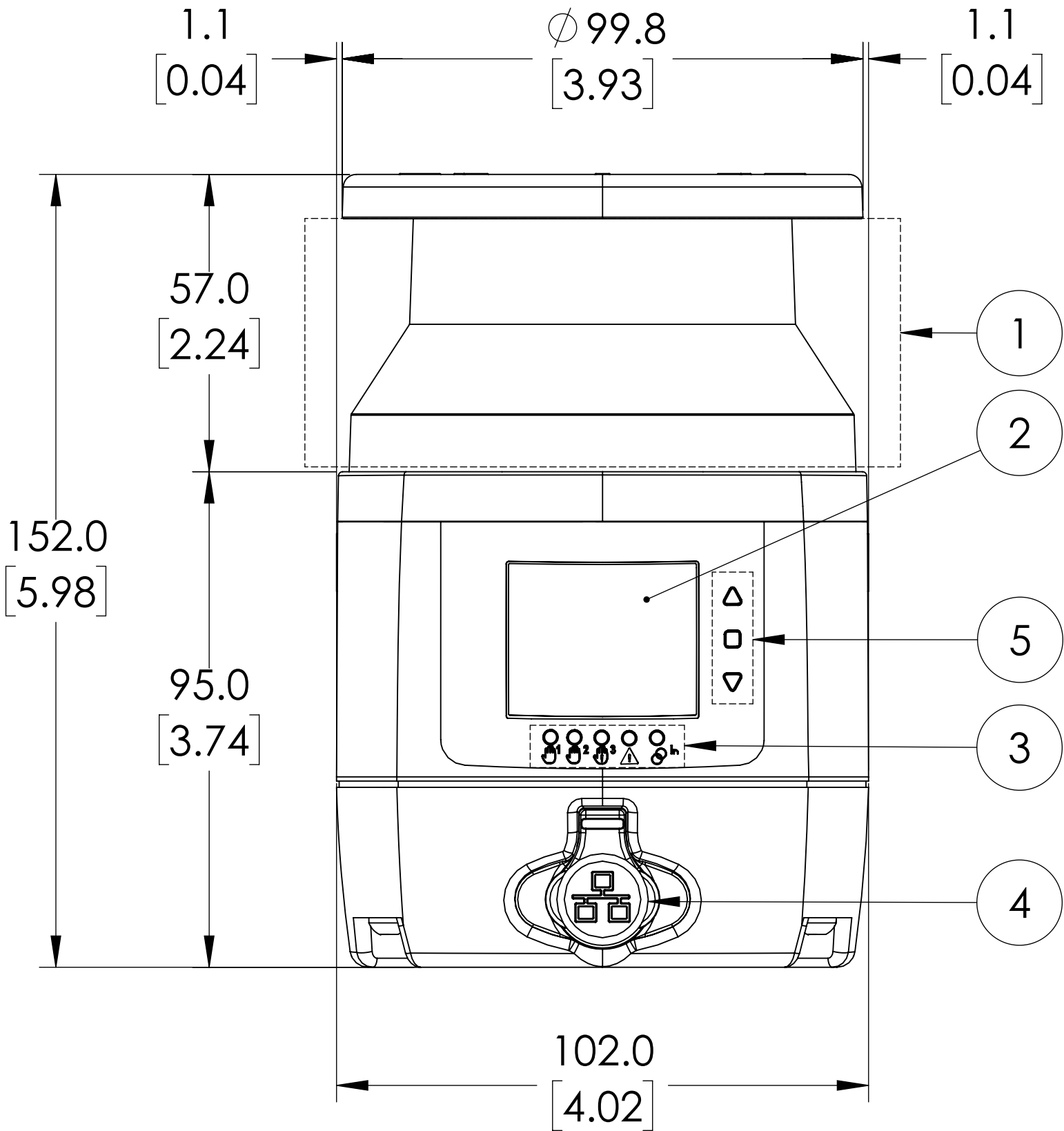
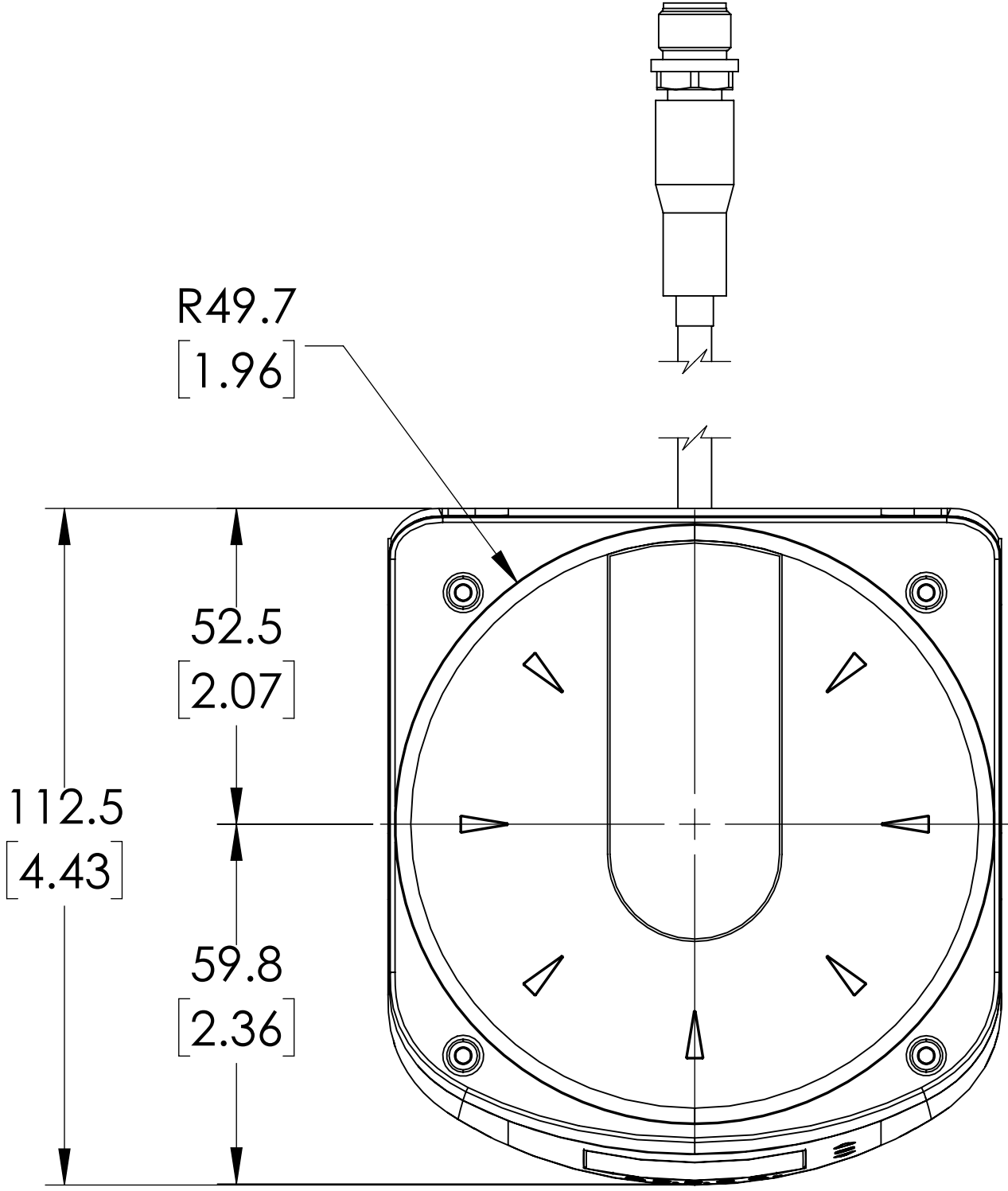

*DEVICE CLASS & WARNING LABEL

NOTES:
1. DIMENSIONS CAN BE CHANGED BY MANUFACTURER WITHOUT NOTICE.
2. DIMENSIONS DO NOT IMPLY TOLERANCE.

SLS-SA3-08

Units: mm [inches]
Scale: Full

DATALOGIC SAFETY LASER SCANNER, AREA PROTECTION, 275 DEGREES OPERATING ANGLE, 0.05 - 3M OPERATING DISTANCE, (1) SAFETY ZONE, (2) WARNING ZONES, 24 VDC, SAFETY CATEGORY TYPE 3, IP65, (1) 4-PIN AND (1) 8-PIN M12 QUICK-DISCONNECT

AUTOMATIONDIRECT.com