

LEFT SIDE VIEW

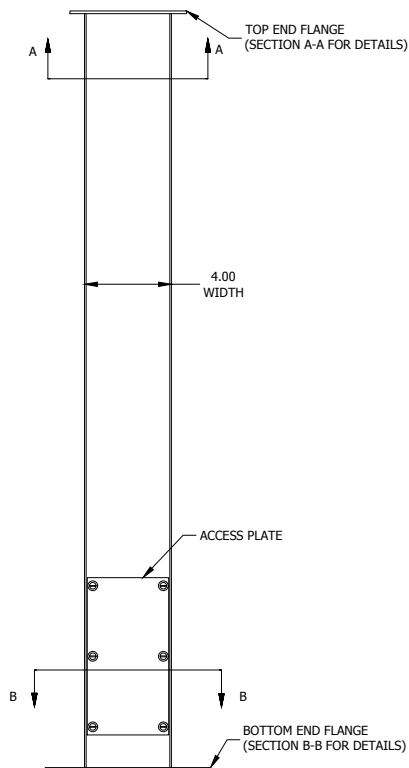

FRONT VIEW

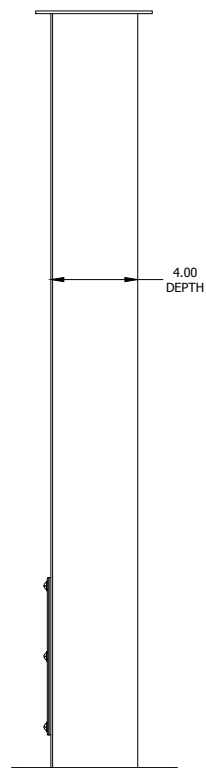

RIGHT SIDE VIEW

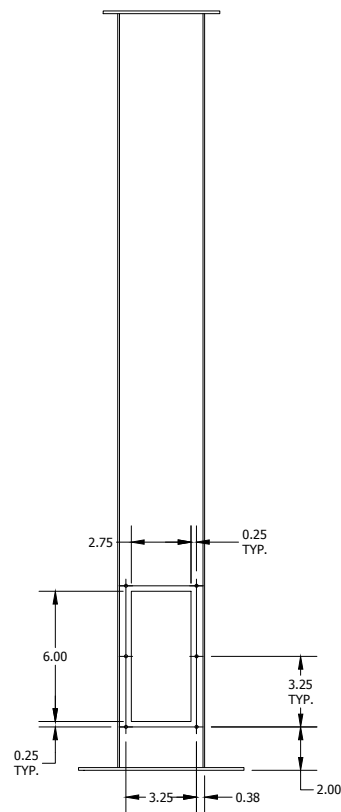

FRONT VIEW
(ACCESS PLATE REMOVED)

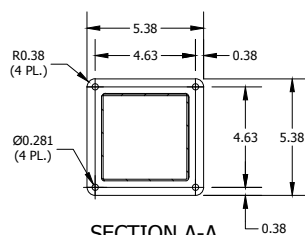

SECTION A-A
(INSIDE TOP VIEW)

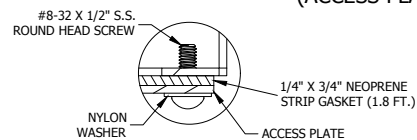

DETAIL A (6 PL.)
(ACCESS PLATE DETAIL)

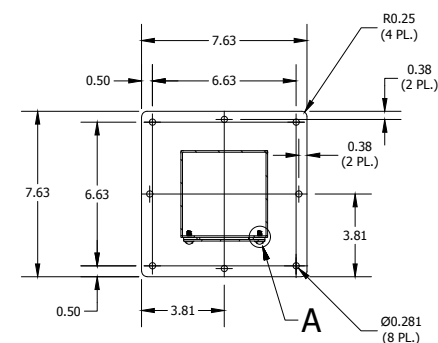
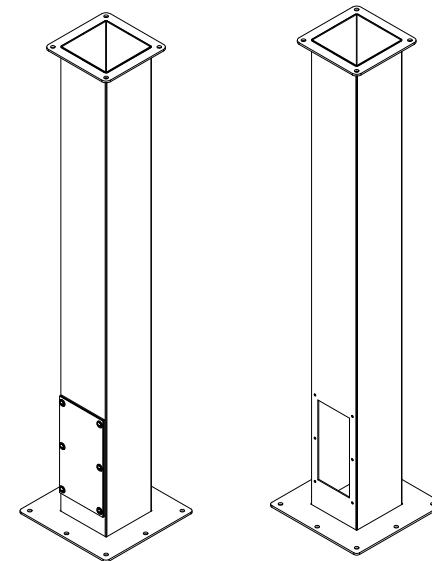

SECTION B-B
(INSIDE BOTTOM VIEW)

PART#: WA44CCOLSS
(DATA SUBJECT TO CHANGE WITHOUT NOTICE)

THIS DRAWING IS PROPERTY OF HUBBELL INC. WIEGMANN
ALL INFORMATION IS PROPRIETARY AND NOT TO BE DUPLICATED