

ISOMETRIC VIEW

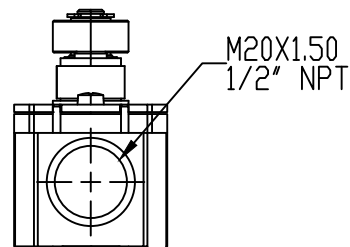

#### NOTES:

1. DIMENSIONS CAN BE CHANGED BY MANUFACTURER WITHOUT NOTICE.
2. DIMENSIONS DO NOT IMPLY TOLERANCE.

Z4VH-335-02Z

Units: mm [inches]

Scale: Full

SCHMERSAL LIMIT SWITCH, SIDE ROTARY  
LEVER W/PLASTIC ROLLER, 90° ADJ. HEAD,  
(2)N.C. CONTACTS, SNAP ACTION, 40.5MM  
WIDE BODY, ALUMINUM, 30MM MOUNT,  
M20X1.50 ENTRY W/1/2" NPT ADAPTER