

ISOMETRIC VIEW

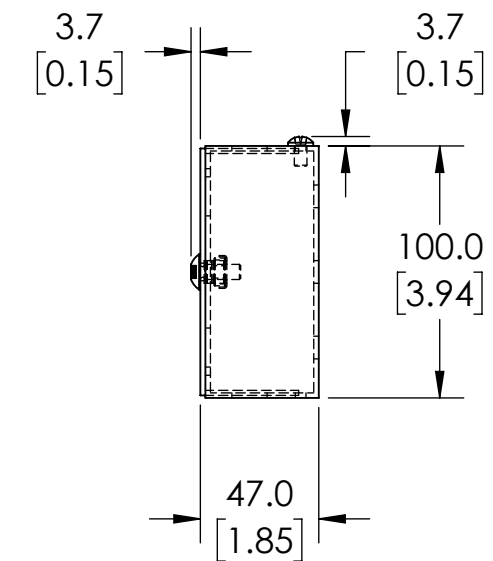

#### NOTES:

1. DIMENSIONS CAN BE CHANGED BY MANUFACTURER WITHOUT NOTICE.
2. DIMENSIONS DO NOT IMPLY TOLERANCE.

ZAK0A1

Units: mm [inches]

Scale: Full

QUADRITALIA OKK SERIES PLINTH FRONT/REAR  
PLATE SET, 100 X 1000MM (HXW), CARBON  
STEEL, RAL 7024 GRAPHITE GRAY, TEXTURED  
POWDER COAT FINISH.