

ISOMETRIC VIEW

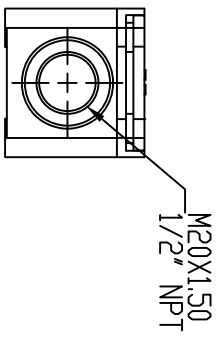

ZS-336-11Z

Units: mm [Inches]

Scale: Full

SCHMERSAL LIMIT SWITCH, METAL PLUNGER, 90° ADJ. HEAD, (1)NO (1)NC, CONTACTS, SNAP ACTION, 40.5MM WIDE BODY, GLASS-FIBER THERMOPLASTIC, 30MM MOUNT M20X1.50 ENTRY W/1/2" NPT ADAPTER

- NOTES:
1. DIMENSIONS CAN BE CHANGED BY MANUFACTURER WITHOUT NOTICE.
 2. DIMENSIONS DO NOT IMPLY TOLERANCE.